



DIRECTIONS:

- 8 oz cream cheese, softened
- 8 oz sour cream
- 1 pkg Island Coconut Sweet Dip mix

Combine ingredients and blend until smooth and creamy. Refrigerate one hour before serving.

Easier Slicing & Peeling!



R101 Regular Paring



R126 Tomato Slicer

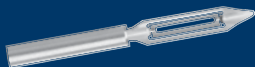

R132 Vegetable Peeler

Recipes for other uses for your Quick Mix at www.RadaQuickMixRecipes.com



Nutrition Facts

Serving Size 2 tsp dry (9g)
Servings Per Container about 12

Amount Per Serving	
Calories 35	Calories from Fat 0
%Daily Value*	
Total Fat 0g	0%
Saturated Fat 0g	0%
Trans Fat 0g	
Cholesterol 0mg	0%
Sodium 25mg	1%
Total Carbohydrate 9g	3%
Dietary Fiber 0g	0%
Sugars 8g	
Protein 0g	
Vitamin A 0%	Vitamin C 50%
Calcium 0%	Iron 0%

INGREDIENTS:

Sugar, Natural Flavors, Salt, Food Starch-Modified, Dextrose, Citric Acid, Dehydrated Pineapple, Ascorbic Acid, Caramel Color, Silicon Dioxide.

ALLERGENS:

NONE

ISLAND COCONUT SWEET DIP

Item # Q904

Net Wt. 3.92 oz (111 g)

